

LINE DEPT:

- Remove Poles, Services and OH Lines.
- Meters removed on Building DEMOs
- Install Anchor and Guy at P# 2-1
- Replace Poles 2 and 2-1
- Build 1PH Riser on P# 2-2
- Install 1PH Prim Junction pole# 2

UG DEPT:

- Install 1 PH Prim from P# 2-2 to PAD 2-1
- Install 50 kVA PAD

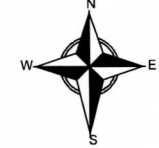

12-28L2
13.2 kV Area

0 38 76 FT

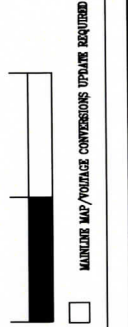

MANURE MAP/POLLICE COMPENSATIONS UPDATE REQUIRED

- Anchor - existing
- Anchor - install
- Anchor - remove
- Conduit - existing
- Cutout (Closed) - install
- Elbow - C phase
- Luminaire - Secondary Connector
- Luminaire - exi_location - Street Light
- OH Transformer (1ph) - existing
- Pad - existing
- Pole (Joint) - existing
- Pole (Joint) - remove
- Pole (Joint) - replace
- Primary OH (1ph) - existing
- Primary OH (3ph) - existing
- Primary OH (1ph) - install
- Primary UG (1ph) - install
- Reference Point - existing
- Riser - existing
- Riser - install
- Secondary OH - existing
- Secondary OH - remove
- Secondary Net Cut - existing
- Secondary Service (OH) - existing
- Secondary Service (UG) - existing
- Secondary Service (OH) - remove
- Service Point - non-critical
- Transformer Connection
- UG Transformer (1ph) - install

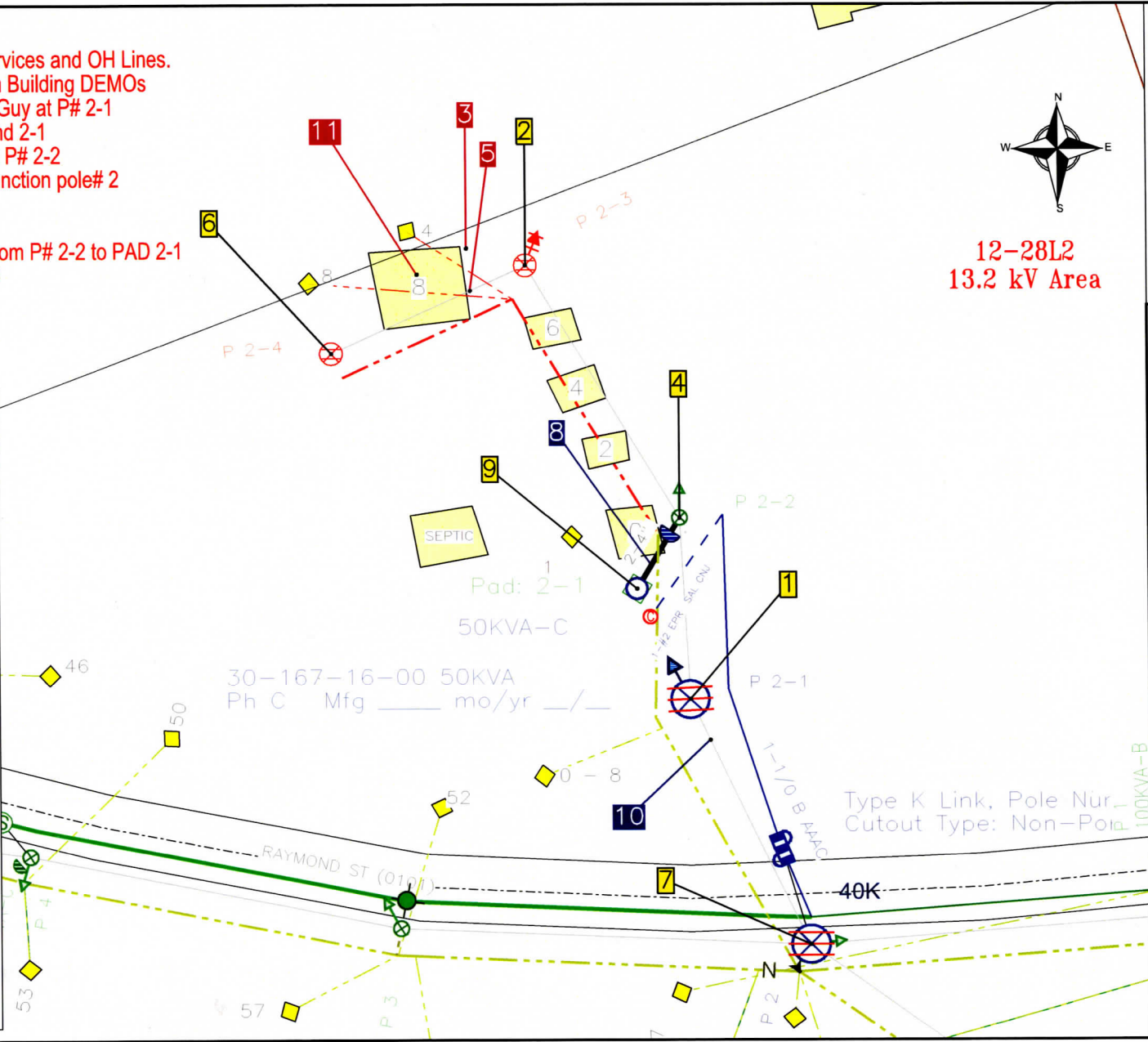

12-22-30561346 1-10

<input type="checkbox"/> BUILT AS DESIGNED	T.D./V.C. 12
<input type="checkbox"/> AS BUILT CHANGES	PROJ. NO.
PHONE NUMBER: 9785242240	SHEET 1 OF 1
DATE:	DATE:
PREP. SIG.	

DESCRIPTION:	
REQUESTING REMOVAL OF POLES AND SECONDARIES ISSUED AT REQUEST OF SIBBITA, JEFF, OWNER, 978-325-057	
EMP. ID:	

NATIONAL GRID USA

WORK REQUEST: 12-22-30561346	DATE: 09/26/2023
FORMS ORDER: 30561346	DESIGNER: Sibbita C, Mahabier-Sheeh
JOB TITLE: Elec Public Requir-1 Road/piper	
FOREMAN SIG:	